

# 87000 Series

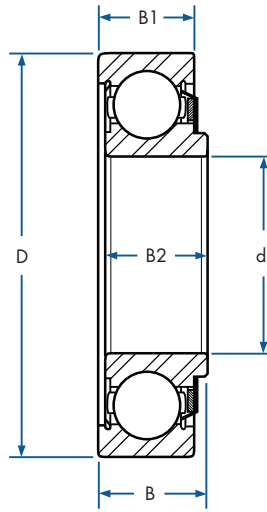

Bearing Size	Dimensions (mm)				Dimensions (inches)			Load Rating (lbs)		Limiting Speed (RPM)
	d		D		B	B1	B2	Dynamic Cr	Static Cor	Grease
	mm	inch	mm	inch		outer	inner	Cr	Cor	
87035	5	0.1969	19	0.7480	0.406	0.315	0.386	524	198	18,400
87036	6	0.2362	19	0.7480	0.406	0.315	0.386	524	198	18,400
87006	6	0.2362	24	0.9449	0.406	0.315	0.386	747	314	18,400
87037	7	0.2756	22	0.8661	0.406	0.315	0.386	740	306	18,400
87007	7	0.2756	24	0.9449	0.406	0.315	0.386	747	317	18,400
87038	8	0.3150	22	0.8661	0.406	0.315	0.386	740	306	18,400
87008	8	0.3150	24	0.9449	0.406	0.315	0.386	747	317	18,400
87009	9	0.3543	30	1.1811	0.500	0.354	0.480	1,025	438	13,600
87500	10	0.3937	30	1.1811	0.500	0.354	0.480	1,047	465	13,600
87011	11	0.4331	32	1.2598	0.500	0.394	0.480	1,047	465	12,000
87501	12	0.4724	32	1.2598	0.500	0.394	0.480	1,375	626	12,000
87013	13	0.5118	32	1.2598	0.500	0.394	0.480	1,375	626	12,000
87014	14	0.5512	35	1.3780	0.500	0.433	0.480	1,375	626	10,400
87502	15	0.5906	35	1.3780	0.500	0.433	0.480	1,525	747	10,400
87016	16	0.6299	35	1.3780	0.500	0.433	0.480	1,525	747	10,400
87602	15	0.5906	42	1.6535	0.590	0.512	0.551	1,525	747	9,400
87503	17	0.6693	40	1.5748	0.563	0.472	0.538	1,940	976	9,600
87603	17	0.6693	47	1.8504	0.630	0.551	0.591	1,940	976	8,800
87504	20	0.7874	47	1.8504	0.625	0.551	0.600	2,885	1,494	8,000
87604	20	0.7874	52	2.0472	0.748	0.591	0.709	2,885	1,494	8,000
87505	25	0.9843	52	2.0472	0.625	0.591	0.625	3,150	1,785	7,120
87605	25	0.9843	62	2.4409	0.827	0.669	0.827	3,150	1,785	6,480
87026	26	1.0236	52	2.0472	0.625	0.591	0.600	3,150	1,785	7,120
87606	30	1.1811	72	2.8346	0.906	0.748	0.906	1,970	1,140	4,640
87507	35	1.3780	72	2.8346	0.827	0.669	0.787	1,970	1,140	5,040
87607	35	1.3780	80	3.1496	0.984	0.827	0.984	2,120	1,330	4,800
87508	40	1.5748	80	3.1496	0.945	0.827	0.945	2,960	1,820	4,480
87608	40	1.5748	90	3.5433	1.063	0.906	1.063	2,960	1,820	4,240
87509	45	1.7717	85	3.3465	0.945	0.827	0.945	3,300	2,050	4,160
87609	45	1.7717	100	3.9370	1.181	0.984	1.181	3,300	2,050	3,760
87510	50	1.9685	90	3.5433	1.024	0.866	1.024	3,560	2,350	3,760
87511	55	2.1654	100	3.9370	1.063	0.906	1.063	4,390	2,970	3,440